

Outline of Block B and C above to receive soffit insulation. Soffit insulation to extend horizontally out from occupied zone above by 1metre in all directions. Column heads below occupied zone above to clad in soffit insulation, extending 1metre downwards from underside of concrete slab.
Perimeter walls and cores (warm zone) to receive insulation.

BASEMENT SIZE: 11707 m²
CARPARKING SPACES: 181
BICYCLE PARKS: 634
MOTORBIKE PARKS: 16

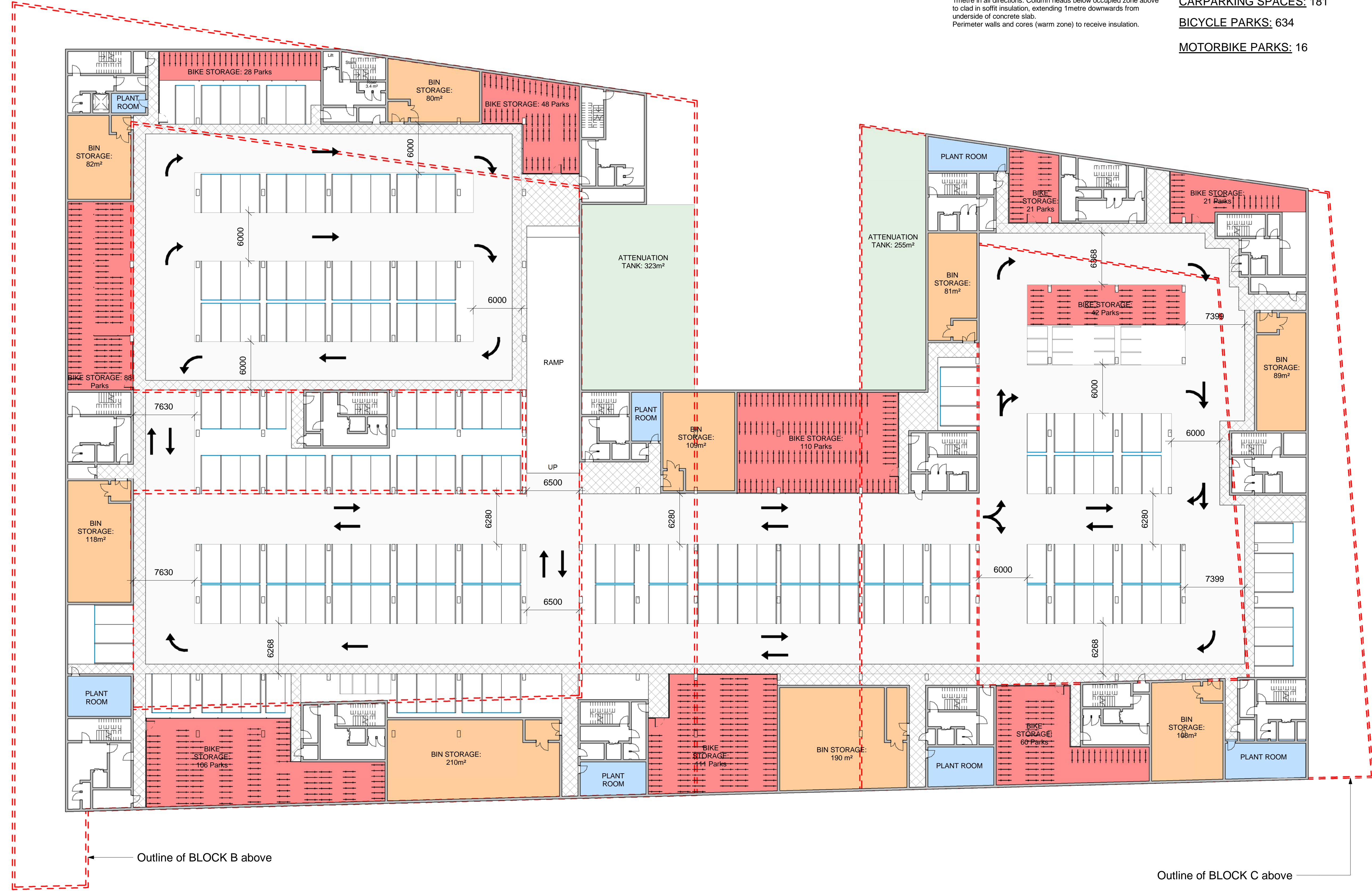

Outline of BLOCK B above

Outline of BLOCK C above

NOTES:

KEY:

REV.	DATE:	DETAILS:	INITIALS:

Copyright of this drawing is vested in the Architect and it must not be copied or reproduced without consent. Figured dimensions only are to be taken from this drawing. All dimensions must be checked and the responsibility for taking and checking all dimensions rests with the client. PLUS Architecture are not liable for any variation between drawing and site conditions. DO NOT SCALE OFF THIS DRAWING. - P IN DOUBT ASK

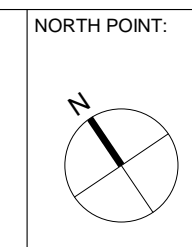

KEY PLAN:

++ PLUSARCHITECTURE Chancery Lane, Dublin 6, Ireland. W: www.plusarchitecture.ie T: 353 (0) 1 521 3378	
PROJECT: 334_Chivers Site, Coolock	PROJECT: 334
CLIENT: PLATINUM LAND	DATE: 13/08/18
TITLE: Proposed Basement Plan	DRAWING NO.: 334_WS_02_01
ISSUE TYPE: Planning	REVISION NO.:
	SCALE AT A1.: 1:250
	DRAWN BY.: JG
	CHECKED BY.: GW
	SCALE AT A3.: 1:500